



**C. 27ACRES (10.92 HECTARES)**

FODEENS  
KILL  
CO. KILDARE

**JORDAN** 

PSRA Reg No. 001536

**FOR SALE BY PRIVATE TREATY**  
**CIRCA 27ACRES (10.92 HECTARES),**  
**FODEENS, KILL, CO. KILDARE.**

**LOCATION:**

The lands are located 4.5km east of Kill, Co. Kildare in the townland of Fodeens. This is an excellent location close to Naas (10km) and The City (20km). The N7 is less than 5 mins drive (Junction 7).

Kill Village benefits from a host of local amenities including shops, school, pubs, restaurant, GAA club and a local bus service.

The entire is close to a number of Golf Clubs including Palmerstown House, Castlewarden Golf & Country Club, The K Club and Killeen Golf Club.

In addition to this Goffs Sales yard is a 5 min drive and there is excellent accessibility to the racecourses of Naas, The Curragh, Punchestown & Leopardstown.

**DESCRIPTION:**

The entire extends to a total area of 27 acres with over 300 metres of road frontage. It is in two divisions with superb mature hedgerows and natural timber. A stream runs along the northern boundary. The land is all in grass but ideal for any purpose.

The entire would make a super site for the construction of a residence and yard subject to obtaining the necessary Planning Permission.

With the land leasing market currently strong the investment merits of acquiring land to take advantage of the tax – free income also presents opportunities.

**TITLE:**

Freehold

**SOLICITOR:**

OMD, Naas, Co. Kildare, 045 - 899485.

**SERVICES:**

Natural water supply & ESB available for connection in the area.

**GUIDE PRICE:**

Price on Application.

**CONTACT:**

**Paddy Jordan**

**T: 045 -433550**

**E: [paddy@jordancs.ie](mailto:paddy@jordancs.ie)**

**Clive Kavanagh**

**T: 045 - 433550**

**E: [clive@jordancs.ie](mailto:clive@jordancs.ie)**





**MAP OF LANDS FOR IDENTIFICATION PURPOSES:**

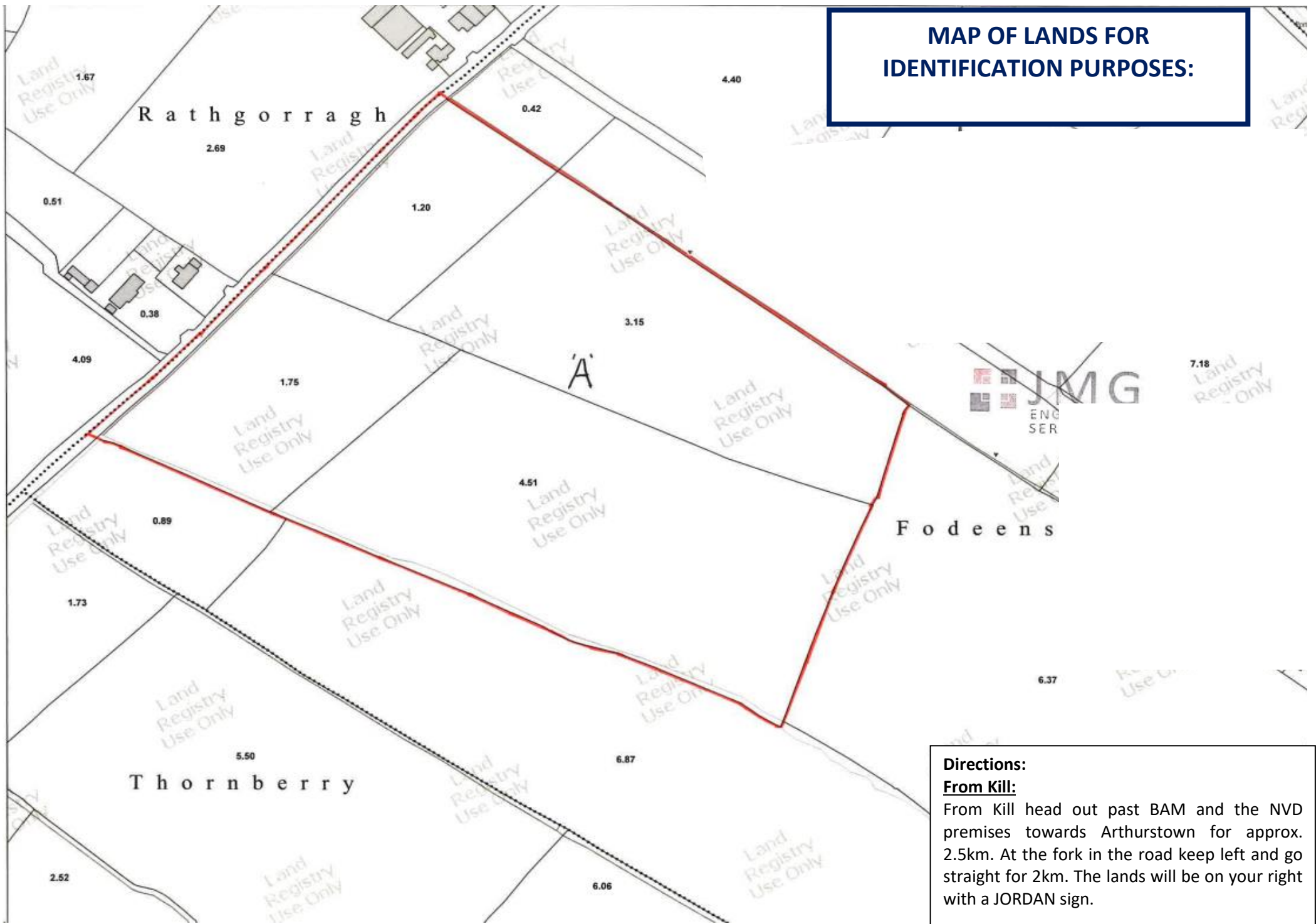

**Directions:**

**From Kill:**

From Kill head out past BAM and the NVD premises towards Arthurstown for approx. 2.5km. At the fork in the road keep left and go straight for 2km. The lands will be on your right with a JORDAN sign.

Kill & N7

